



AusPress®

STAINLESS



**Installed quickly & easily,
AusPress Stainless is installed
without flame as the preferred
method for installing grade 316
stainless pipework.**



profile



10 to 168.3mm

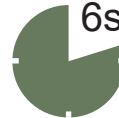

Press a 28mm fitting onto
the stainless tube in under
6 seconds. Join done.

Faster to Install

AusPress press-fit offers large time savings compared to welding, threading, grooving or glueing.

Safer to Use

- We train your team onsite.
- One button tool operation.
- Lightweight battery tools.
- No flames or hot work permits.
- No heavy gas tanks.
- No hazardous fumes.
- Less risk.

Experience Counts

- We were the first to supply press-fit stainless in Australia & New Zealand.
- We work with consultants & installers on specialised complex projects regularly.

Quality to Install

- Approved to WaterMark, ActivFire, Australian & International standards.
- **Material traced from coil to tube & fittings (3.1 certs).**
- Superior temperature tolerance.
- **TIG welded stainless tube 15 - 108mm.**

Reliable Design

- Suits a wide range of applications.
- Permanent high strength with the original 'M' press join profile.
- Consistent low profile join look & quality each time.

Environmental Choice

- Long service life.
- Closed loop material (completely recycled to make more stainless).
- Efficient and waste free install.



Installing AusPress®



DN 15 to 168mm

Start to install quicker...

AusPress press-fit is installed easily & quickly using a Press Tool to form a permanent 'M' profile pressed joint between tube and fitting.



Start here

Check for suitability...

Both the piping material (eg 316L stainless steel) and the elastomer (the rubber ring seal) must be checked if suitable for the conveyed fluid and exterior environments.

This guide is for standard applications. For different or specialised applications please contact us first.

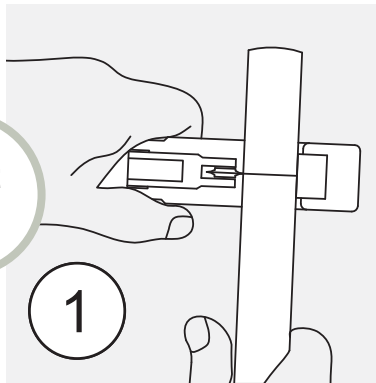

Cut to Length

Cut the tube at right angles using a tube cutter or fine tooth saw.

Note: Using the same cutting tool on different metals can lead to corrosion (eg steel then stainless).

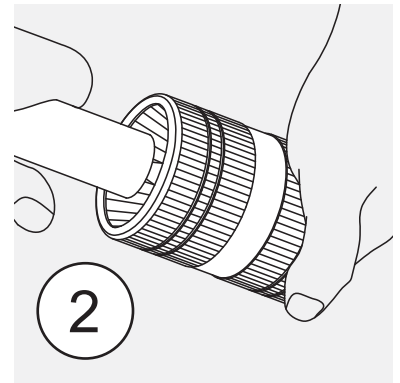

Deburr Tube

Deburr both inside & outside edges of the tube to prevent damage to the ring seal of the fitting.

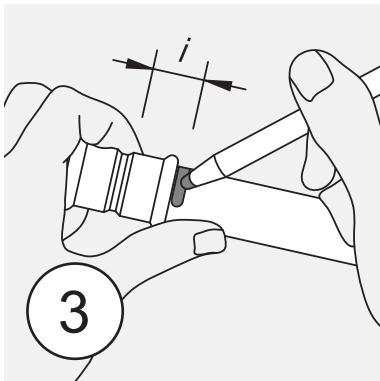

Mark the Insertion Depth "i"

Measure or use a depth gauge to mark the insertion depth (socket depth) onto the tube end.

This is a visual quality control mark to ensure the tube is fully inserted.

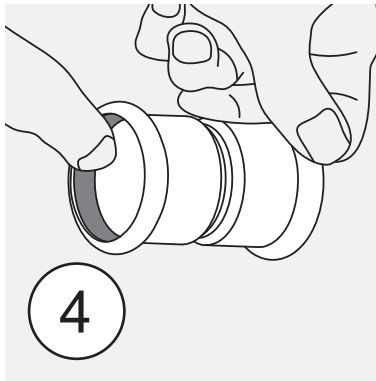

Inspect Fitting & Ring Seals

Check that the rubber ring seal is:

- The correct material type (colour) of seal is used.
- The seal is not damaged.
- Both fitting & seal are free of debris.

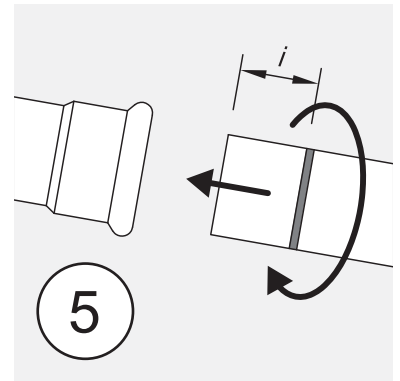

Join the Tube & Fitting

Insert the tube into the fitting press socket, turning slightly until it reaches the previously marked insertion depth.

Soapy water can be used if joining is difficult.

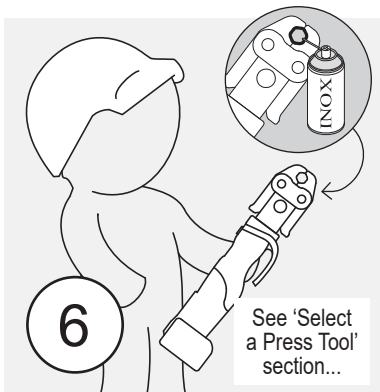

Press Tool Selection

Select the correct press tool, jaw or collar to suit the fitting, dimension and application pressures. Ensure press zone is lubricated each press with Inox spray.

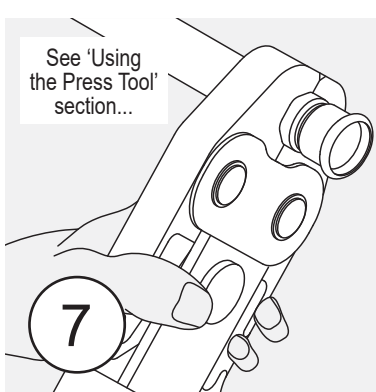

Press the Join

Open the press tool jaw, align with the press socket and start the Press Tool to join the fitting & tube.

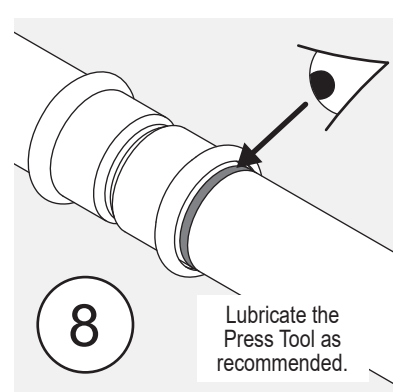

Check & Complete

Visually inspect the pressed fitting & that the insertion mark is aligned with the end of the socket.



Select a Press Tool

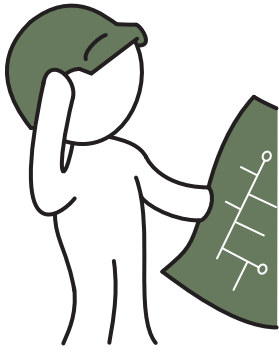

The right tool for the job...

Our fleet of tools are designed to install AusPress press-fit quickly & consistently without the need for welding or threading to form a permanent join.

We offer hire, purchasing and servicing for our Press Tools.

Our trained Sales Executives can meet onsite for Press Tool training to meet your OH&S requirements and we maintain records of attendees.

Start here

Metric Press-Fit

316 SS 304 SS

Press fittings onto AusPress Metric stainless tube from us.

OD Press-Fit Diameters:

10 - 35mm



Press Jaw

42 & 54mm

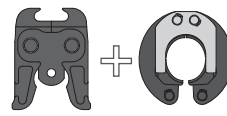

Adaptor Jaw & Collar

76.1 - 108mm

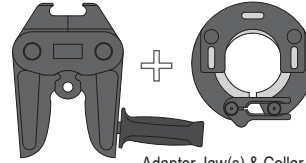

Adaptor Jaw(s) & Collar

168.3mm

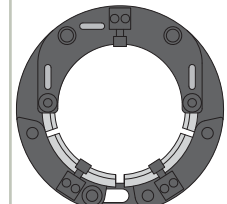

Press Collar

Max Working Pressure for completed pipework*:

25 bar 362 psi

25 bar 362 psi

16 bar 232 psi

25 bar 362 psi

Single Press 16 bar
Double Press 20 bar or hot water

Press Tool Options:

SPM24



ACO203



6 sec press

CPN700

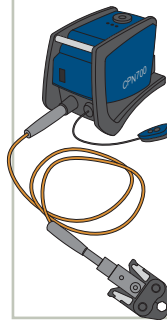

ACO203-XL



CPN700

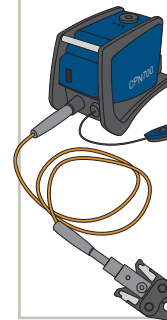

ACO401

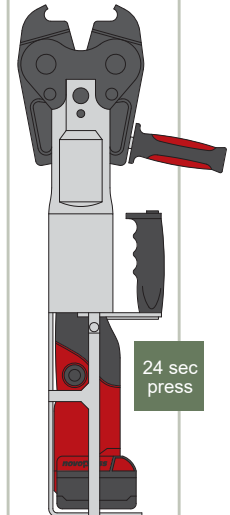

24 sec press

This tool is not suitable for gas or compressed air installations.

Joint Log Book: For project QA



Now available

The 'M' Profile Press...

AusPress press tools are calibrated to suit our products and although they may look similar to others, the tolerances of the systems are different.

Our tooling recognises the difference and does not complete a full press. Any warranty or similar is void as a result.

Please Note:

This chart is a guide and full specifications and instructions are available on request.

* This value is the Maximum Working Pressure, not the safety or testing pressure of the system. Maximum also depends on the application - check with us first.

16 bar ≈ 1,600 kPa
16 bar ≈ 232 psi
25 bar ≈ 2,500 kPa
25 bar ≈ 362 psi



AusPress Metric Stainless Range

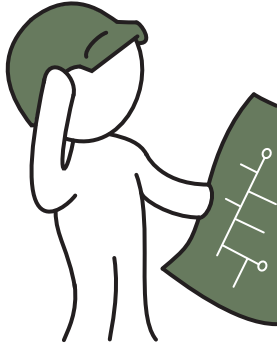

What Stainless Grade should I use?

We stock grade 316L and 304L stainless steel tube in metric diameters to suit the AusPress press-fit range.

Fittings are supplied in 316L stainless steel and are compatible with either 304L or 316L metric tube.

Please ask us if you require more information or technical advice for your project.

There is more than just cost differences between the two types.

For technical information for specialised projects please ask us. We've over 24 years experience, have access to testing metallurgist services too.

Tube Bending:

Tube diameters up to 35mm can be cold bent with a commercial bender to a radius no less than 3.5x the tube diameter.

Eg: 15 (tube dia) x 3.5 = 52.5mm radius min along the centre line.

Refer to our Technical Data Sheets for material suitability and resistance.

Tube Metric OD Stainless

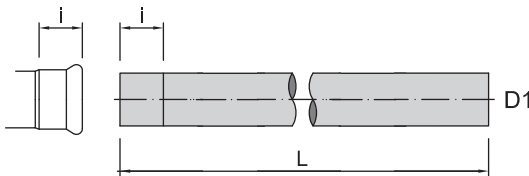

Tubes are TIG welded 15 to 108mm.

OD \swarrow \nwarrow **OD**

i = insertion depth. Tube must be inserted into the press socket a minimum distance to ensure the join is pressed successfully.

D1 (mm)	DN	i depth	Length (L)	t Wall	Tube Weights (kg)			Product No	Product No	D1 (mm)
					dry/m	dry/6m	wet/m			
10	8	10	3m	1.0	0.2	1.4	0.3	316.93.010	-	10
15	12	20	6m	1.0	0.4	2.1	0.5	316.96.015	304.96.015	15
22	20	21	6m	1.2	0.6	3.8	0.9	316.96.022	304.96.022	22
28	25	23	6m	1.2	0.8	4.9	1.3	316.96.028	304.96.028	28
35	32	26	6m	1.5	1.3	7.6	2.1	316.96.035	304.96.035	35
42	40	30	6m	1.5	1.5	9.2	2.7	316.96.042	304.96.042	42
54	50	35	6m	1.5	2.0	11.9	4.0	316.96.054	304.96.054	54
76.1	80	53	6m	2.0	3.7	16.9	7.8	316.96.076	304.96.076	76.1
88.9	90	58	6m	2.0	4.4	26.3	10.0	316.96.088	304.96.088	88.9
108	100	69	6m	2.0	5.3	32.1	13.8	316.96.108	304.96.108	108
168.3	150	121	6m	2.0	8.4	50.3	29.6	316.96.168	-	168.3

Common Applications [‡]	SS 2205	SS 316	SS 304
Potable Water	Suitable	Suitable	Suitable
Compressed Air	Suitable	Suitable	Suitable
Hot Water Supply	Suitable	Suitable	Suitable
Food Processing Areas	Suitable	Suitable	Suitable
Fuels & Oil Supply	Suitable	Suitable	Suitable
Material Cost	More than 316	More than 304	Less than 316
Resistance to Chemicals [‡]	More than 316	More than 304	Less than 316
Resistance to Chlorides [‡]	More than 316	More than 304	Less than 316
Performance at Elevated Temperatures	More than 316	More than 304	Less than 316

[‡] Some chemicals can be unsuitable with stainless steel. Please contact us for confirmation before installing with a Project Info Sheet and any MSDS details.

DUPLEX AusPress press-fit is now available in the high grade 2205 duplex stainless! Check out our 2205 Duplex catalogue for the new range of tube & fittings.

■ Installation Tools

These items make installing Blucher Press-Fit easier.

Remember using the same cutting or deburring tool on different metals can lead to corrosion (eg cut steel then cut stainless steel).

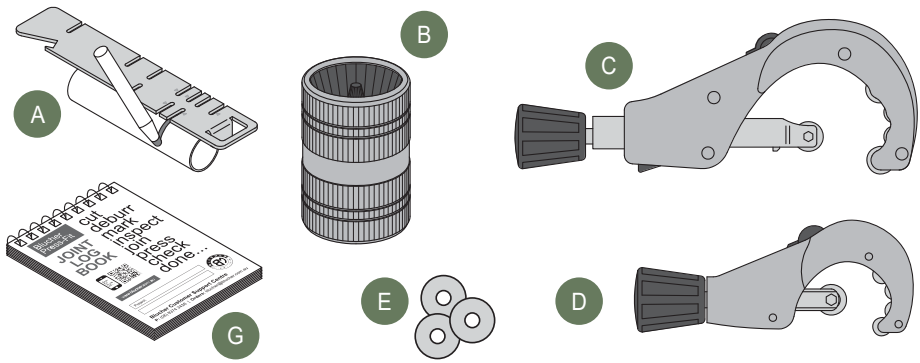

Press Tools:

Information and capacities are listed under "Select a Press Tool" Section.

10mm

10mm fittings are also available at the end of this section.

Image	Suits...	Product No
A	Depth Gauge 'Type B'	10 - 168.3mm BA.DGAUGE.010.168
B	Manual Deburrer	10 - 54mm VT.DEB
C	Manual Tube Cutter	6 - 76.1mm VT.TCUT.006.076
D	Manual Tube Cutter	3 - 45mm VT.TCUT.003.045
E	Replacement Cutting Wheel for 'C & D' (each)	VT.TCUT.WHEEL
G	Blucher Press-Fit Joint Log Book	BA.BM007-06

■ Coupling Socket - Socket

10
Also available

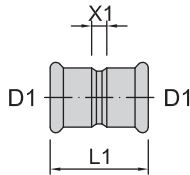
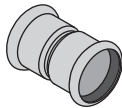

Material: 316L stainless steel.

Ring Seal: EPDM x2 supplied.

Product No	D1	L1	X1
316.21.015	15	48	8
316.21.022	22	51	8
316.21.028	28	52	8
316.21.035	35	70	18
316.21.042	42	78	18
316.21.054	54	86	18
316.21.076	76.1	141	33
316.21.088	88.9	160	45
316.21.108	108	197	58
316.21.168	168.3	300	64

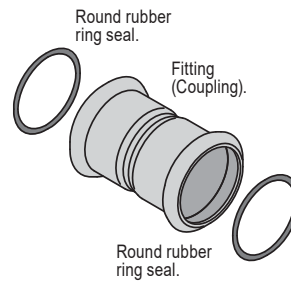

Rubber Ring Seals

Depending on the application, the ring seals may need to be changed to a different type for higher chemical or temperature resistance.

More info in the ring seal product listing.

■ Spigot Reducer Socket - Tube End

10
Also available

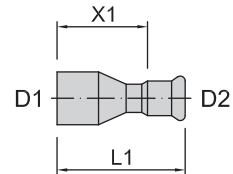
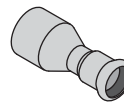

Material: 316L stainless steel.

Ring Seal: EPDM x1 (D2) supplied.

Product No	D1	D2	L1	X1
316.23.022.015	22	15	64	44
316.23.028.015	28	15	68	48
316.23.028.022	28	22	65	46
316.23.035.015	35	15	77	57
316.23.035.022	35	22	81	62
316.23.035.028	35	28	74	52
316.23.042.015	42	15	85	65
316.23.042.022	42	22	86	67
316.23.042.028	42	28	82	60
316.23.042.035	42	35	88	62
316.23.054.015	54	15	92	72
316.23.054.022	54	22	92	73
316.23.054.028	54	28	93	71
316.23.054.035	54	35	101	75
316.23.054.042	54	42	101	71
316.23.076.054	76.1	54	132	98
316.23.088.054	88.9	54	162	128
316.23.088.076	88.9	76.1	179	126
316.23.108.054	108	54	179	145
316.23.108.076	108	76.1	198	145
316.23.108.088	108	88.9	206	148
316.23.168.088	168.3	88.9	379	321
316.23.168.108	168.3	108	360	289

■ Slip Coupling Socket - Socket

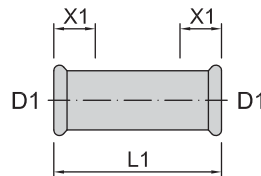
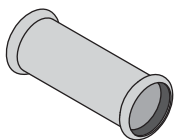

Material: 316L stainless steel.

Ring Seal: EPDM x2 supplied.

Product No	D1	L1	X1min
316.22.015	15	80	28
316.22.022	22	71	20
316.22.028	28	89	22
316.22.035	35	99	26
316.22.042	42	114	30
316.22.054	54	136	34
316.22.076	76.1	226	54
316.22.088	88.9	255	58
316.22.108	108	300	72



■ Tee Equal Socket Ends & Branch

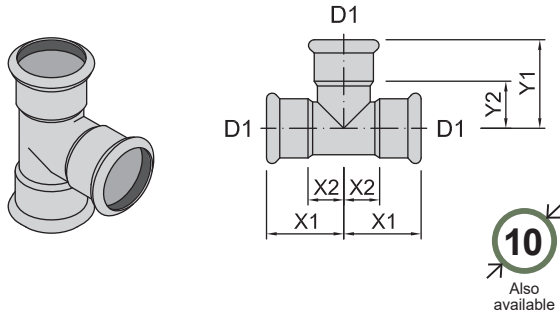

Material: 316L stainless steel.

Ring Seal: EPDM x3 supplied.

Product No	D1	X1	X2	Y1	Y2
316.51.015	15	32	12	39	19
316.51.022	22	36	16	42	21
316.51.028	28	41	19	47	25
316.51.035	35	50	24	53	27
316.51.042	42	57	27	60	30
316.51.054	54	68	34	71	37
316.51.076	76.1	113	59	110	55
316.51.088	88.9	128	72	128	69
316.51.108	108	150	81	154	85
316.51.168	168.3	257	139	235	118

■ Tee Reduced Socket Ends & Branch

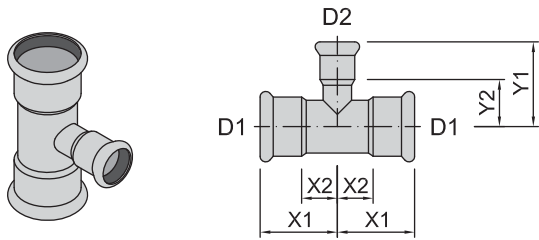

Material: 316L stainless steel.

Ring Seal: EPDM x3 supplied.

Product No	D1	D2	X1	X2	Y1	Y2
316.52.022.015	22	15	36	16	42	22
316.52.028.015	28	15	41	19	45	25
316.52.028.022	28	22	41	19	45	25
316.52.035.015	35	15	50	24	48	28
316.52.035.022	35	22	50	24	48	28
316.52.035.028	35	28	50	24	51	28
316.52.042.015	42	15	57	27	52	32
316.52.042.022	42	22	57	27	51	31
316.52.042.028	42	28	57	27	53	31
316.52.042.035	42	35	57	27	57	31
316.52.054.015	54	15	68	34	57	38
316.52.054.022	54	22	68	34	57	38
316.52.054.028	54	28	68	34	60	38
316.52.054.035	54	35	68	34	63	37
316.52.054.042	54	42	68	34	67	37
316.52.076.022	76.1	22	113	59	68	48
316.52.076.028	76.1	28	113	59	72	49
316.52.076.035	76.1	35	113	59	74	48
316.52.076.042	76.1	42	113	59	76	46
316.52.076.054	76.1	54	113	59	83	47
316.52.088.022	88.9	22	128	72	75	55
316.52.088.028	88.9	28	128	72	79	56
316.52.088.035	88.9	35	128	72	81	55
316.52.088.042	88.9	42	128	72	83	53
316.52.088.054	88.9	54	128	72	90	54
316.52.088.076	88.9	76.1	128	72	115	63
316.52.108.022	108	22	150	81	84	64
316.52.108.028	108	28	150	81	88	65
316.52.108.035	108	35	150	81	90	64
316.52.108.042	108	42	150	81	95	65
316.52.108.054	108	54	150	81	99	65
316.52.108.076	108	76.1	150	81	127	73
316.52.108.088	108	88.9	150	81	136	74
316.52.168.076	168.3	76.1	257	139	157	103
316.52.168.088	168.3	88.9	257	139	167	110
316.52.168.108	168.3	108	257	139	182	111

■ FI Tee Socket Ends - FI BSP Branch

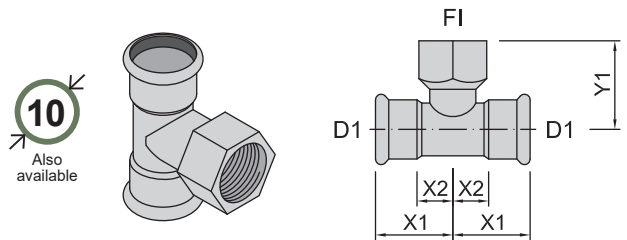

Material: 316L stainless steel.

Ring Seal: EPDM x2 supplied.

Product No	D1	FI BSP	X1	X2	Y1
316.53.015.015	15	1/2"	32	12	36
316.53.022.015	22	1/2"	36	16	39
316.53.022.020	22	3/4"	36	16	44
316.53.028.015	28	1/2"	41	19	42
316.53.028.020	28	3/4"	41	19	46
316.53.028.025	28	1"	41	19	47
316.53.035.015	35	1/2"	50	24	45
316.53.035.020	35	3/4"	50	24	50
316.53.042.015	42	1/2"	57	27	48
316.53.042.020	42	3/4"	57	27	52
316.53.054.015	54	1/2"	68	34	55
316.53.054.020	54	3/4"	68	34	58
316.53.054.050	54	2"	68	34	76
316.53.076.020	76.1	3/4"	113	59	71
316.53.076.050	76.1	2"	113	59	91
316.53.088.020	88.9	3/4"	128	70	78
316.53.088.050	88.9	2"	128	70	97
316.53.108.020	108	3/4"	150	81	87
316.53.108.050	108	2"	150	81	107

■ MI Tee Socket Ends - MI BSP Branch

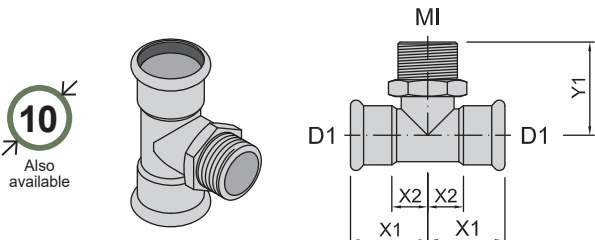

Material: 316L stainless steel.

Ring Seal: EPDM x2 supplied.

Product No	D1	MI BSP	X1	X2	Y1
316.54.015.015	15	1/2"	32	12	36
316.54.022.020	22	3/4"	36	16	44
316.54.022.025	22	1"	42	19	49
316.54.028.025	28	1"	41	19	50
316.54.035.032	35	1 1/4"	50	24	57

90 Bend Socket - Socket

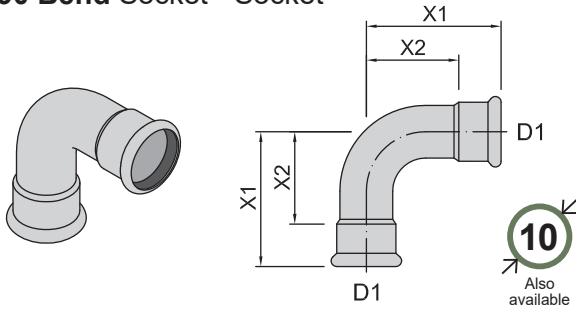

Material: 316L stainless steel.

Ring Seal: EPDM x2 supplied.

Product No	D1	X1	X2
316.31.090.015	15	48	28
316.31.090.022	22	61	40
316.31.090.028	28	72	49
316.31.090.035	35	74	48
316.31.090.042	42	86	56
316.31.090.054	54	106	72
316.31.090.076	76.1	177	124
316.31.090.088	88.9	181	123
316.31.090.108	108	214	140
316.31.090.168	168.3	386	268

45 Bend Socket - Socket

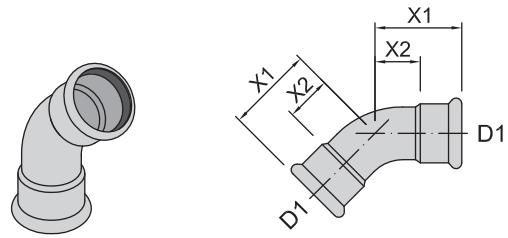

Material: 316L stainless steel.

Ring Seal: EPDM x2 supplied.

Product No	D1	X1	X2
316.31.045.015	15	35	15
316.31.045.022	22	41	20
316.31.045.028	28	46	24
316.31.045.035	35	55	29
316.31.045.042	42	68	38
316.31.045.054	54	81	47
316.31.045.076	76.1	111	58
316.31.045.088	88.9	114	56
316.31.045.108	108	138	64
316.31.045.168	168.3	252	134

90 Bend Socket - Tube End

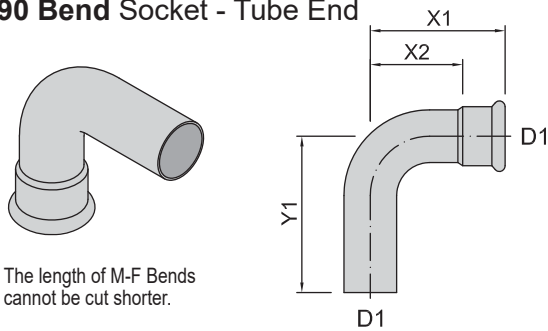

The length of M-F Bends cannot be cut shorter.

Material: 316L stainless steel.

Ring Seal: EPDM x1 supplied.

Product No	D1	X1	X2	Y1
316.32.090.015	15	48	28	67
316.32.090.022	22	61	40	74
316.32.090.028	28	72	49	82
316.32.090.035	35	74	48	85
316.32.090.042	42	86	56	97
316.32.090.054	54	105	72	122
316.32.090.076	76.1	177	124	195
316.32.090.088	88.9	181	123	202
316.32.090.108	108	214	140	240
316.32.090.168	168.3	386	268	404

45 Bend Socket - Tube End

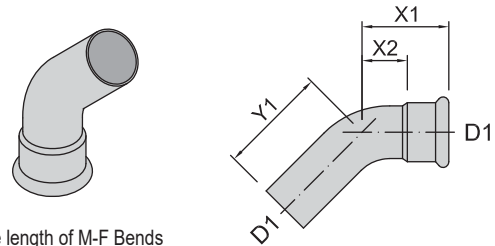

The length of M-F Bends cannot be cut shorter.

Material: 316L stainless steel.

Ring Seal: EPDM x1 supplied.

Product No	D1	X1	X2	Y1
316.32.045.015	15	35	15	47
316.32.045.022	22	40	20	52
316.32.045.028	28	46	24	58
316.32.045.035	35	55	29	69
316.32.045.042	42	68	38	78
316.32.045.054	54	81	47	92
316.32.045.076	76.1	111	58	128
316.32.045.088	88.9	114	56	135
316.32.045.108	108	138	64	169
316.32.045.168	168.3	252	134	253

90 Bend Tube End - Tube End

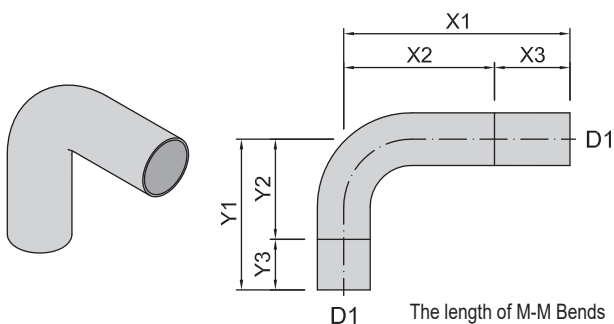

The length of M-M Bends can be cut back to the dashed line maximum.

Material: 316L stainless steel.

Product No	D1	X1	X2	X3	Y1	Y2	Y3
316.33.090.015	15	120	58	62	70	58	12
316.33.090.022	22	120	70	50	70	63	7
316.33.090.028	28	120	80	40	80	70	10
316.33.090.035	35	200	100	100	120	80	40
316.33.090.042	42	250	120	130	150	100	50
316.33.090.054	54	300	145	155	200	120	80

Tube up to 35mm diameter can be bent using a commercial tube bender - refer to the technical section for more information.



Are you using the correct type of ring seal?

■ **FI 90 Bend Socket - FI BSP**

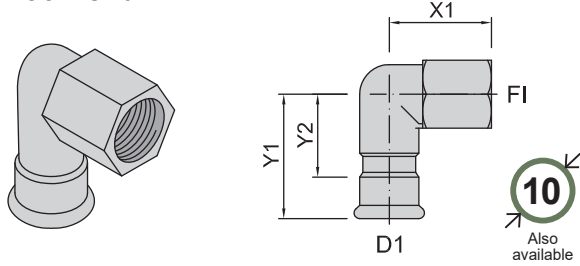

Material: 316L stainless steel. Ring Seal: EPDM x1 supplied.

Product No	D1	FI BSP	X1	Y1	Y2
316.34.015.015	15	1/2"	37	57	37
316.34.022.020	22	3/4"	46	59	39
316.34.028.025	28	1"	54	67	44
316.34.035.032	35	1 1/4"	63	75	49

■ **MI 90 Bend Socket - MI BSP**

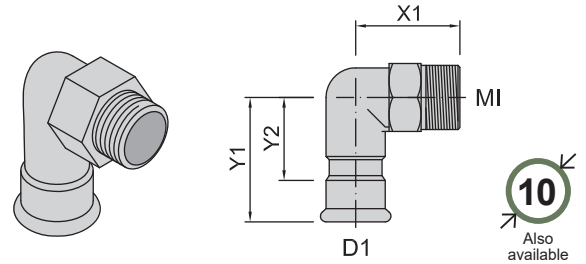

Material: 316L stainless steel. Ring Seal: EPDM x1 supplied.

Product No	D1	MI BSP	X1	Y1	Y2
316.35.015.015	15	1/2"	37	57	37
316.35.022.020	22	3/4"	46	59	39
316.35.028.025	28	1"	54	67	44
316.35.035.032	35	1 1/4"	63	75	49
316.35.042.040	42	1 1/2"	67	84	54
316.35.054.050	54	2"	78	93	60

■ **FI 90 Bend with Wall Plate Socket - FI BSP**

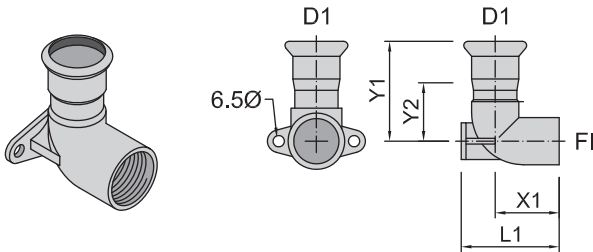

Material: 316L stainless steel. Ring Seal: EPDM x1 supplied.

Product No	D1	FI BSP	L1	X1	Y1	Y2
316.36.015.015	15	1/2"	44	30	50	28
316.36.022.020	22	3/4"	51	34	54	33

■ **Adaptor Flange Socket - Flange**

Material: 316L stainless steel. Ring Seal: EPDM x1 supplied.

Product No	D1	FL	D3	L1	X1	t	PCD	ØB
316.71.015A	15	ANSI 150	90	35	15	11.5	60.5	16 x4
316.71.022A	22	ANSI 150	98	42	21	13	70	16 x4
316.71.028A	28	ANSI 150	108	52	29	14.5	79.5	16 x4
316.71.035A	35	ANSI 150	117	64	38	16	89	16 x4
316.71.042A	42	ANSI 150	127	75	45	17.5	98.5	16 x4
316.71.054A	54	ANSI 150	152	68	33	19.5	120.5	20 x4
316.71.076A	76.1	ANSI 150	191	113	60	24	152.5	20 x4
316.71.088A	88.9	ANSI 150	191	127	67	24	152.5	20 x4
316.71.108A	108	ANSI 150	229	150	81	24	190.5	20 x8
316.71.168A	168.3	ANSI 150	280	150	29	25.5	241.3	23 x8

Note: ANSI flange dimensions flange dimensions 't', 'X1' & 'L1' include the raised face height of 1.5mm.

316.71.015E	15	Table E	95	35	15	6	67	14 x4
316.71.022E	22	Table E	100	42	21	6	73	14 x4
316.71.028E	28	Table E	115	52	29	7	83	14 x4
316.71.035E	35	Table E	120	64	38	8	87	14 x4
316.71.042E	42	Table E	135	75	45	9	98	14 x4
316.71.054E	54	Table E	150	68	33	10	114	18 x4
316.71.076E	76.1	Table E	185	113	60	11	146	18 x4
316.71.088E	88.9	Table E	185	127	67	11	146	18 x4
316.71.108E	108	Table E	215	150	81	13	178	18 x8
316.71.168E	168.3	Table E	280	150	29	17	235	22 x8

Blank flanges are also stocked to suit Adaptor Flanges listed. Use product no 316.79...

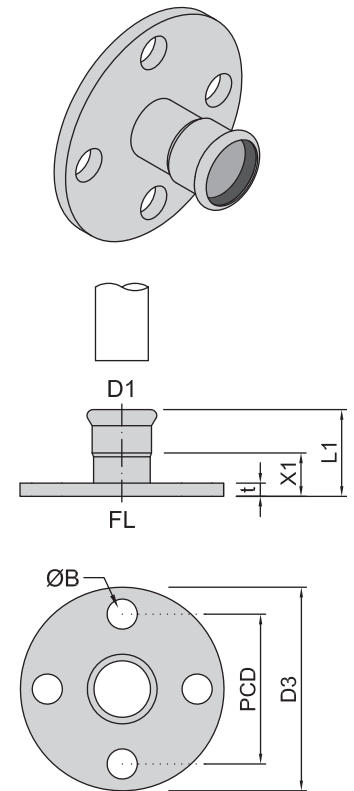

Flanges are welded internally & externally.

FI Adaptor Socket - FI BSP

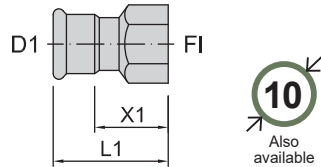
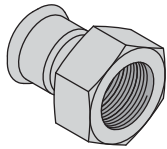

Material: 316L stainless steel.

Ring Seal: EPDM x1 supplied.

Product No	D1	FI BSP	L1	X1
316.73.015.015	15	1/2"	54	34
316.73.015.020	15	3/4"	58	38
316.73.022.015	22	1/2"	52	32
316.73.022.020	22	3/4"	55	35
316.73.022.025	22	1"	58	38
316.73.028.015	28	1/2"	55	32
316.73.028.020	28	3/4"	60	37
316.73.028.025	28	1"	60	37
316.73.028.032	28	1 1/4"	66	43
316.73.035.025	35	1"	64	38
316.73.035.032	35	1 1/4"	69	43
316.73.035.040	35	1 1/2"	73	47
316.73.042.032	42	1 1/4"	72	42
316.73.042.040	42	1 1/2"	77	47
316.73.054.040	54	1 1/2"	82	48
316.73.054.050	54	2"	90	56

FI Adaptor Tube End - FI BSP

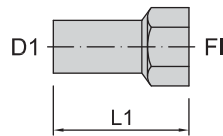
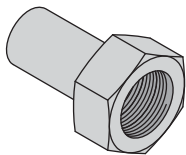

The length of this fitting cannot be cut shorter.

Material: 316L stainless steel.

Product No	D1	FI BSP	L1
316.75.015.015	15	1/2"	58
316.75.022.015	22	1/2"	58
316.75.022.020	22	3/4"	62
316.75.028.020	28	3/4"	68
316.75.028.025	28	1"	69

RG Adaptor Socket - Roll Groove

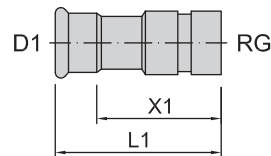
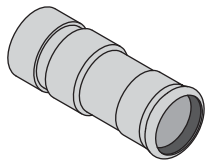

Material: 316L stainless steel.

Ring Seal: EPDM x1 supplied.

Product No	D1	RG	L1	X1
316.77.015.015	15	1/2"	84	64
316.77.022.020	22	3/4"	86	65
316.77.028.025	28	1"	89	66
316.77.035.032	35	1 1/4"	97	71
316.77.042.040	42	1 1/2"	105	75
316.77.054.050	54	2"	116	81
316.77.076.080	76.1	3"	170	117
316.77.088.090	88.9	3 1/2"	170	110
316.77.108.100	108	4"	155	86
316.77.168.150	168.3	6"	195	74

MI Adaptor Socket - MI BSP

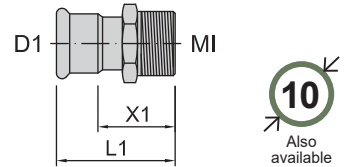
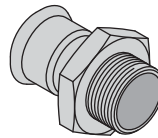

Material: 316L stainless steel.

Ring Seal: EPDM x1 supplied.

Product No	D1	MI BSP	L1	X1
316.74.015.015	15	1/2"	54	34
316.74.015.020	15	3/4"	58	38
316.74.022.015	22	1/2"	53	34
316.74.022.020	22	3/4"	57	38
316.74.022.025	22	1"	61	41
316.74.028.020	28	3/4"	60	38
316.74.028.025	28	1"	63	41
316.74.028.032	28	1 1/4"	67	45
316.74.035.025	35	1"	67	41
316.74.035.032	35	1 1/4"	71	45
316.74.035.040	35	1 1/2"	74	48
316.74.042.032	42	1 1/4"	75	45
316.74.042.040	42	1 1/2"	78	48
316.74.054.040	54	1 1/2"	82	48
316.74.054.050	54	2"	84	50
316.74.076.065	76.1	2 1/2"	128	74
316.74.076.080	76.1	3"	142	86
316.74.088.080	88.9	3"	155	73

This fitting is also available with a NPT thread.

MI Adaptor Tube End - MI BSP

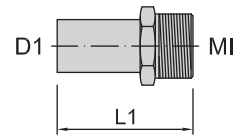
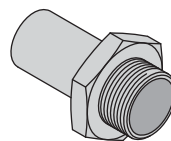

The length of this fitting cannot be cut shorter.

Material: 316L stainless steel.

Product No	D1	MI BSP	L1
316.76.015.015	15	1/2"	60
316.76.022.020	22	3/4"	64
316.76.028.025	28	1"	71
316.76.035.030	35	1 1/4"	81
316.76.042.040	42	1 1/2"	88
316.76.054.050	54	2"	93

End Cap Socket End

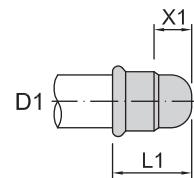

Material: 316L stainless steel.

Ring Seal: EPDM x1 supplied.

Product No	D1	L1	X1
316.24.015	15	36	16
316.24.022	22	40	21
316.24.028	28	42	20
316.24.035	35	51	25
316.24.042	42	54	24
316.24.054	54	59	25
316.24.076	76.1	90	36
316.24.088	88.9	102	45
316.24.108	108	125	56



FI Union Socket - FI BSP

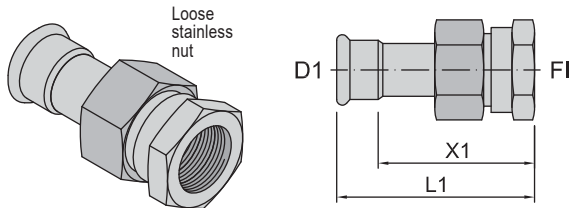

Material: 316L stainless steel.

Ring Seal: EPDM x1 supplied.
Gasket Seal: EPDM x1 supplied.

Product No	D1	FI BSP	L1	X1	Gasket Size
316.81.015.015	15	1/2"	67	47	A
316.81.015.020	15	3/4"	69	49	A
316.81.022.020	22	3/4"	74	54	B
316.81.022.025	22	1"	77	58	B
316.81.028.025	28	1"	85	63	C
316.81.035.032	35	1 1/4"	96	70	D
316.81.042.040	42	1 1/2"	105	95	E
316.81.054.050	54	2"	127	93	F

Note: FI Union is not suitable for gas or steam applications.

Ring Seals

Fittings with a press-fit socket are fitted with an EPDM rubber ring seal as standard.

Depending on the media, this ring seal should be changed to a different rubber material to suit the application.

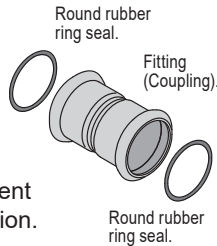

Refer to our relevant Technical Media Chart for suitability or contact us for more information.

Type:	Pre-fitted in fitting standard	Optional extra	Optional extra
	EPDM	FKM (Viton)	NBR
Colour:	Black	Red or Green	Yellow or Grey
Temp:	-20°C to +110°C	-20°C to +200°C	-20°C to +70°C
D1	Product No	Product No	Product No
10	see note...	FKM.11.010	-
15	EPDM.11.015	FKM.11.015	NBR.11.015
22	EPDM.11.022	FKM.11.022	NBR.11.022
28	EPDM.11.028	FKM.11.028	NBR.11.028
35	EPDM.11.035	FKM.11.035	NBR.11.035
42	EPDM.11.042	FKM.11.042	NBR.11.042
54	EPDM.11.054	FKM.11.054	NBR.11.054
76.1	EPDM.11.076	FKM.11.076	NBR.11.076
88.9	EPDM.11.088	FKM.11.088	NBR.11.088
108	EPDM.11.108	FKM.11.108	NBR.11.108
168.3	EPDM.11.168	FKM.11.168	-

Note: For 10mm Blucher Mini-Press, only FKM type ring seals are available and are supplied pre-fitted.

MI Union Socket - MI BSP

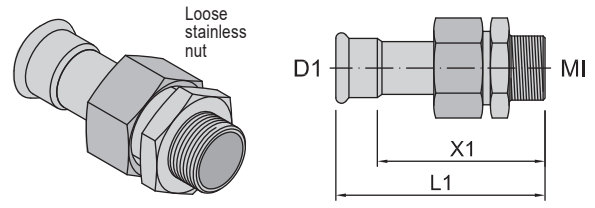

Material: 316L stainless steel.

Ring Seal: EPDM x1 supplied.
Gasket Seal: EPDM x1 supplied.

Product No	D1	MI BSP	L1	X1	Gasket Size
316.82.015.015	15	1/2"	72	52	A
316.82.015.020	15	3/4"	75	55	A
316.82.022.015	22	1/2"			B
316.82.022.020	22	3/4"	79	78	B
316.82.022.025	22	1"			B
316.82.028.025	28	1"	91	69	C
316.82.035.032	35	1 1/4"	105	79	D
316.82.042.040	42	1 1/2"	113	83	E
316.82.054.050	54	2"	134	100	F

Note: MI Union is not suitable for gas or steam applications.

Union Gaskets

Union fittings are fitted with a (flat) rubber gasket seal and a (round) ring seal, both EPDM as standard.

Depending on the media, **both seals** should be changed to a different rubber material to suit the application.

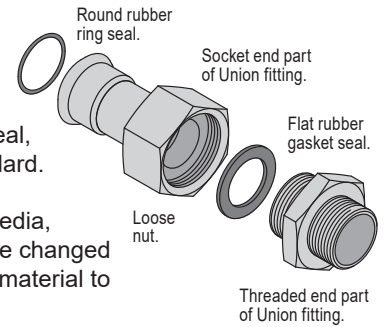

Type:	Pre-fitted in fitting standard	Optional extra
	EPDM	FKM (Viton)
Colour:	Black	Red or Green
Temp:	-20°C to +110°C	-20°C to +200°C
Size	X1 X2	Product No
A	15 24	EPDM.12.015 FKM.12.015
B	22 29	EPDM.12.022 FKM.12.022
C	26 39	EPDM.12.028 FKM.12.028
D	32 45	EPDM.12.035 FKM.12.035
E	40 56	EPDM.12.042 FKM.12.042
F	45 55	EPDM.12.054 FKM.12.054

Unions are not approved to be used for gas or steam applications.

Refer to our Technical Data Sheets for ring seal suitability and resistance.

Ball Valve 2 Piece FI BSP

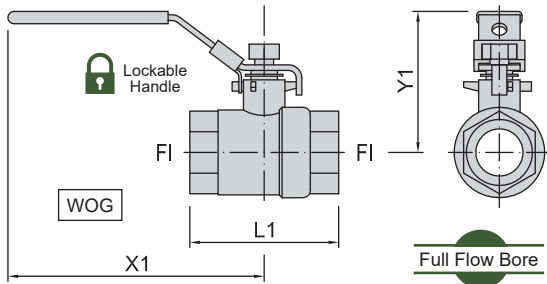

Body: CF8M stainless steel (cast version of 316). Handle Colour: blue.
Ball, Stem & Lever: 316 stainless steel. Working Temp: -20 to 180°C.
Seat: Teflon (PTFE). Cold Working Pressure: 6,895kPa (69 bar or 1,000psi).

Product No	FI BSP	L1	X1	Y1
316.BV2.006	1/4"	48	100	48
316.BV2.010	3/8"	48	100	48
316.BV2.015	1/2"	58	100	52
316.BV2.020	3/4"	66	127	61
316.BV2.025	1"	77	127	65
316.BV2.032	1 1/4"	90	154	79
316.BV2.040	1 1/2"	98	154	83
316.BV2.050	2"	121	192	97

*Check suitability of chemicals with us before ordering or installing.
Larger sizes are available on request.

Ball Valve 3 Piece FI BSP

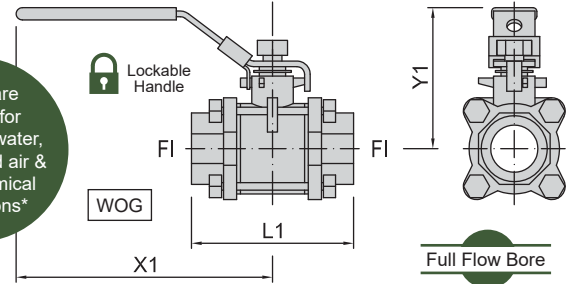

Valves are suitable for hot & cold water, compressed air & many chemical applications*

Body: CF8M stainless steel (cast version of 316). Handle Colour: blue.
Ball, Stem & Lever: 316 stainless steel. Working Temp: -20 to 180°C.
Seat: Teflon (PTFE). Cold Working Pressure: 6,895kPa (69 bar or 1,000psi).

Product No	FI BSP	L1	X1	Y1
316.BV3.006	1/4"	50	100	48
316.BV3.010	3/8"	50	100	48
316.BV3.015	1/2"	64	100	52
316.BV3.020	3/4"	71	127	61
316.BV3.025	1"	81	127	65
316.BV3.032	1 1/4"	94	154	79
316.BV3.040	1 1/2"	104	154	83
316.BV3.050	2"	127	192	97

*Check suitability of chemicals with us before ordering or installing.
Larger sizes are available on request.

Cover Flange (Escutcheon Plate)

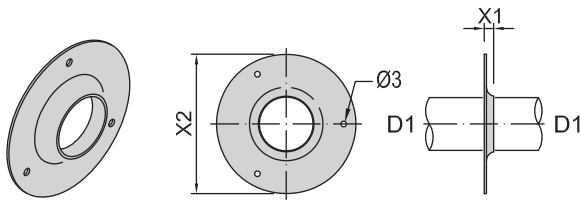

Material: 316L stainless steel.

Finish: 2B surface.

Product No	D1	X1	X2
316.CF.015	15	5	40
316.CF.022	22	5	58
316.CF.028	28	5	74
316.CF.035	35	5	91
316.CF.042	42	5	110
316.CF.054	54	5	140

Brackets

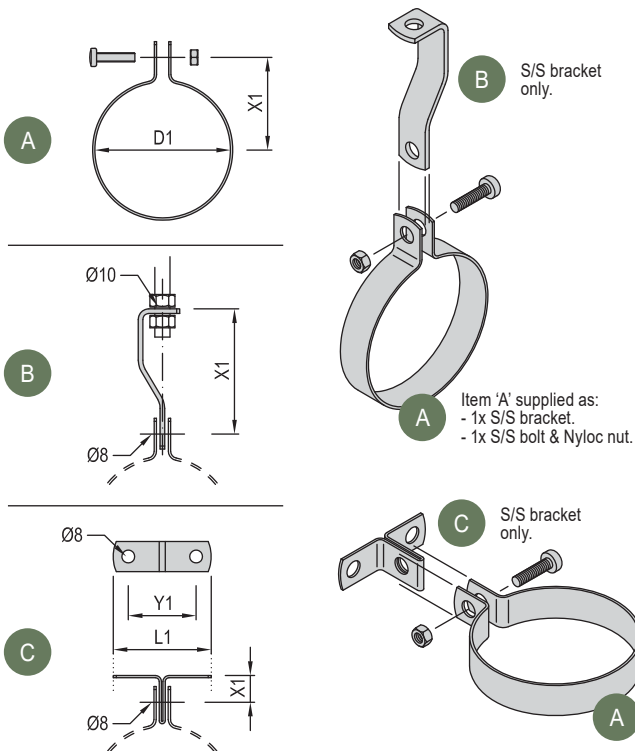

Material: 316L stainless steel.

Product No	Image	D1	L1	X1	Y1
316.CH.015	A	15	-	27	-
316.CH.022	A	22	-	28	-
316.CH.028	A	28	-	33	-
316.CH.035	A	35	-	34	-
316.CH.042	A	42	-	39	-
316.CH.054	A	54	-	45	-
316.CH.076	A	76.1	-	55	-
316.CH.088	A	88.9	-	61	-
316.CH.108	A	108	-	70	-
316.SB1	B	-	-	80	-
316.SB4	C	-	67	12-22	46

Item 'A' supplied as:
- 1x S/S bracket.
- 1x S/S bolt & Nyloc nut.



Blucher Mini-Press Metric Tube (10mm)

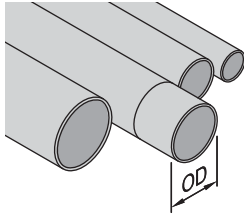

Tubes are TIG weld construction.

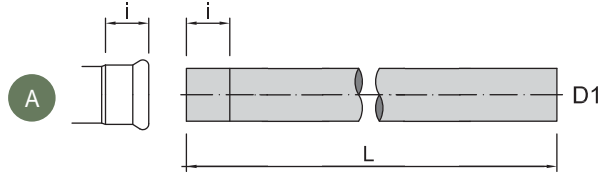

The same great Blucher Press-Fit design, now **mini!**

Blucher Mini-Press is designed for instrument & compressed air.

All 10mm fittings are prefitted with FKM ring seals standard.

Mini-Press is not intended for or approved for potable water.

i = insertion depth. Tube must be inserted into the press socket a minimum distance to ensure the joint is pressed successfully.

Image	Product No	Description	D1 (mm)	DN	<i>i</i> depth	L (mm)	t Wall	Weight/lm (dry-wet)
A	316.93.010	Tube 10mm	10	8	10	3000	1.0	0.2 - 0.3 kg

Blucher Mini-Press Fittings (10mm)

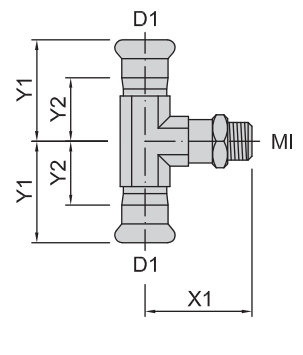
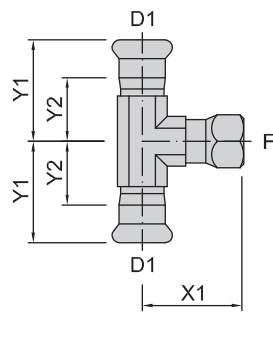
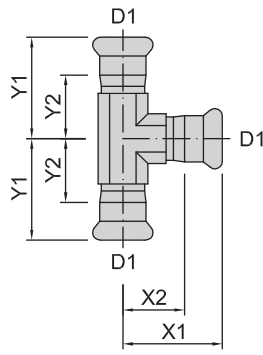
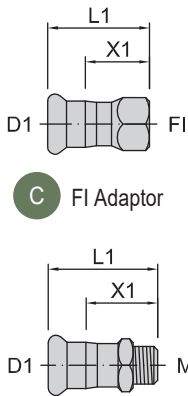
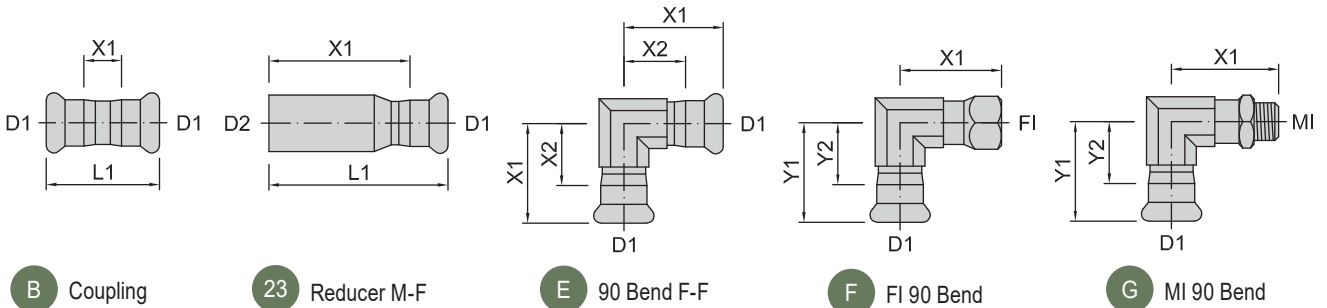

Material: 316L stainless steel.

Ring Seal: FKM only, refer table below for quantity per item.

Image	Product No	Description	D1	D2 or MI or FI	L1	X1	X2	Y1	Y2	Ring Seal Qty
B	316V.21.010	Coupling	10	-	30	10	-	-	-	2
23	316V.23.015.010	Reducer M-F	10	15	48	38	-	-	-	1 (10mm)
C	316V.73.010.010	FI Adaptor	10	3/8" BSP	27	17	-	-	-	1
D	316V.74.010.010	MI Adaptor	10	3/8" BSP	29	19	-	-	-	1
E	316V.31.090.010	90 Bend F-F	10	-	-	26	16	-	-	2
F	316V.34.010.010	FI 90 Bend	10	3/8" BSP	-	27	-	26	16	1
G	316V.35.010.010	MI 90 Bend	10	3/8" BSP	-	28	-	26	16	1
H	316V.51.010	Tee Equal	10	-	-	26	16	27	17	3
I	316V.53.010.010	FI Tee	10	3/8" BSP	-	26	-	27	17	2
J	316V.54.010.010	MI Tee	10	3/8" BSP	-	28	-	27	17	2

↑ V = The 'V' in a Product Number indicates FKM (Viton) ring seals are pre-fitted in this item.

Refer to our Technical Data Sheets for material suitability and resistance.